



*Atlas Copco*



# GTG40 Angle Turbine Grinder

Feel the power. Boost the performance.

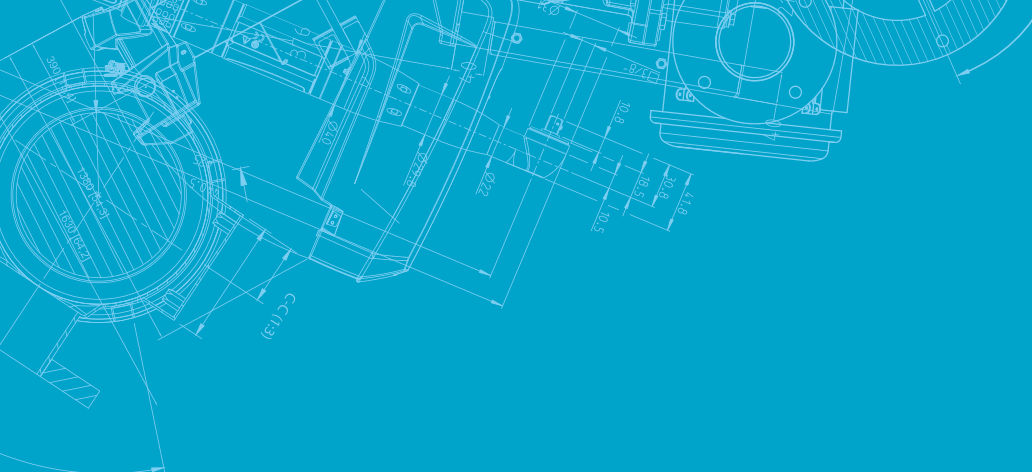

Arguably the most powerful handheld grinder on the market, the GTG40 angle turbine grinder sets the standards in the industry. Thanks to its revolutionary one step turbine motor, the tool takes less time to do the same job. Delivering incredible power for its size and weight, the GTG40 range solves your rough grinding applications.



Integrated  
Autobalancer

Ergonomic  
light weight  
design

Highest  
material  
removal rate  
in its class



Highly efficient turbine motor

Overspeed shut-off device

Precise speed governor

Reduced risk of vibration related injuries

Increased accessibility

Adjustable wheel guard

## MORE EFFECTIVE

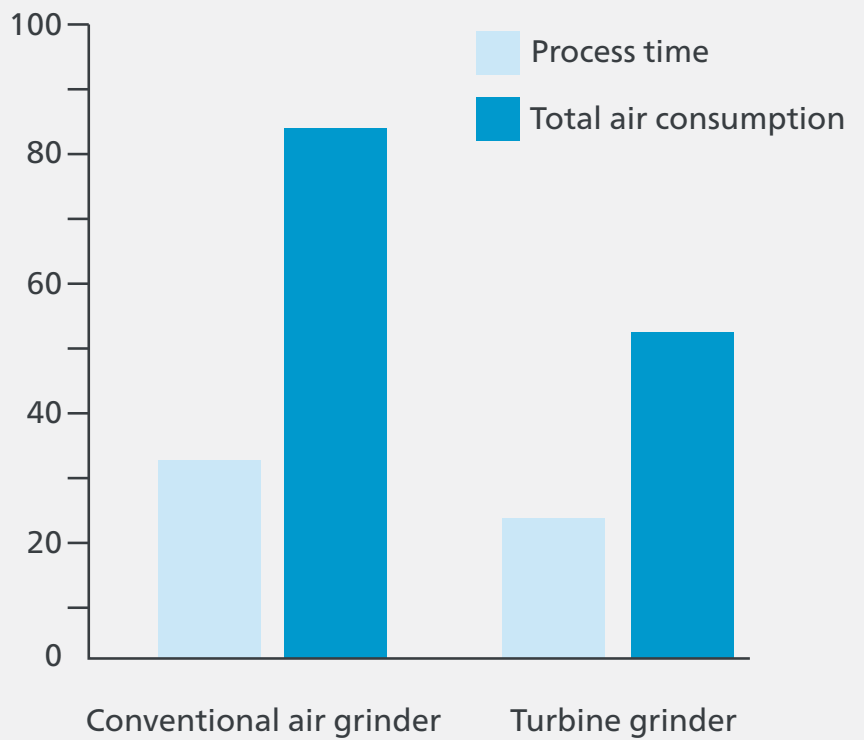

The turbine motor is more efficient than a conventional grinder motor. Therefore it takes less time to do the same job. Also the total air consumption will be a lot less for a specific job.

Model	Max free speed (r/min)	Max output (Kw)	Max wheel/ pad dia (mm)	Spindle thread	Spindle length (mm)	Weight (kg)	Height (mm)	Height over spindle (mm)	Air consumption at max output (l/s)	Air consumption at free speed (l/s)	Rec. hose size (mm)	Air inlet thread BSP	Auto balancer	Ordering No.
<b>Grinder</b>														
GTG40 F085-18	8500	4.5	180			3.8	128	99	60	20	16	1/2"	Yes	8423 2900 10
GTG40 F066-23	6600	4.5	230			4.0	128	99	60	20	16	1/2"	Yes	8423 2910 10
<b>Sander</b>														
GTG40 S060	6000	4.5	140	5/8-11 UNC	22.3	3.6	132	122	60	20	16	1/2"	Yes	8423 2930 00
<b>Cup wheel &amp; wire brush</b>														
GTG40 S060-C15	6000	4.5	150	5/8-11 UNC	22.3	4.3	160	123	60	20	16	1/2"	Yes	8423 2930 10

Tool accessories	Ordering No.
Add on spot suction Ø 180-230 mm	3780 4032 12
Hand shield	4175 0165 90
Vibration damped handle	4150 1521 80
Adapter for positioning support handle 120/135°	4175 0164 90
Heavy duty backing pad for sanding Ø 180 mm (7")	4170 1192 90
Friction plate complete	4175 0186 90

Air line accessories	Ordering No.
MultiFlex swivel, 1/2" BSP	8202 1350 60
Productivity kit, MAXI-FRL-1-BSP, with claw coupling, 5m hose	8202 0850 05
<b>FRL Stand</b>	
FRL-STAND-MAXI-BSP	9090 3030 14
Hose kit 1/2" inch Tool Inlet BSP (5m)	8202 1181 82



How to assemble a dust extraction kit



MultiFlex Swivel Connector: An ergonomic solution



Increase productivity with Atlas Copco's air preparation units – FRL range

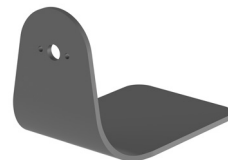

Hand shield

**Atlas Copco**

**Atlas Copco AB**  
 (publ) SE-105 23 Stockholm, Sweden  
 Phone: +46 8 743 80 00  
 Reg. no: 556014-2720  
 atlascopco.com